

[www.magnum.fr](http://www.magnum.fr)

# MUSEE d'ORSAY

## Etude de projection

20/06/2025

## Projection Plafond : Pour Atteindre +100 Lux

11 DUAL de 35K Lumens Ainsi de chaque coté . 30M de base par Stack de Dual

Soit 22 Projecteurs de chaque coté

Donc 44 Projecteurs au Total

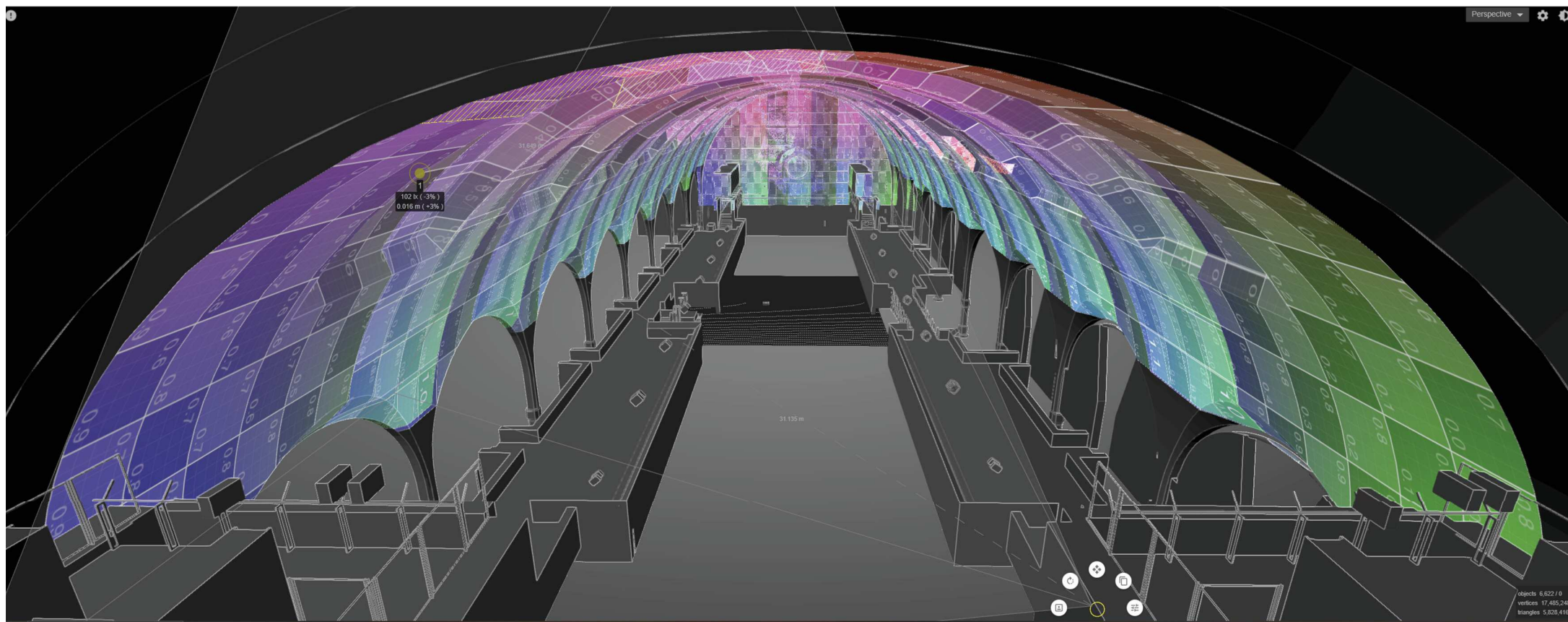

Synoptique v									
Document Name :	MAG_TEMPLATE_Visio_V2			Version :	1	<div>Légende :</div> <div><div><div></div>SMF DUO</div><div><div></div>SMF QUAD</div><div><div></div>MTP12</div><div><div></div>MTP24</div><div><div></div>USB</div></div> <div><div></div>BEETEK 4x LC</div> <div><div></div>DISPLAY PORT</div> <div><div></div>SDI</div> <div><div></div>HDMI</div> <div><div></div>RJ45</div> <div><div></div>XLR Intercom</div> <div><div></div>XLR Audio</div>			
Author :	Anthony Martel	Co-author :							
Mail :	A.martel@magnum.fr	Venue :	99 Rue de Paris 95500 Gonesse - FR						
Tel :	+33 1.30.11.60.90	Print :	05/03/2025						



Zone de couverture  
Plafond Coté TYMPAN

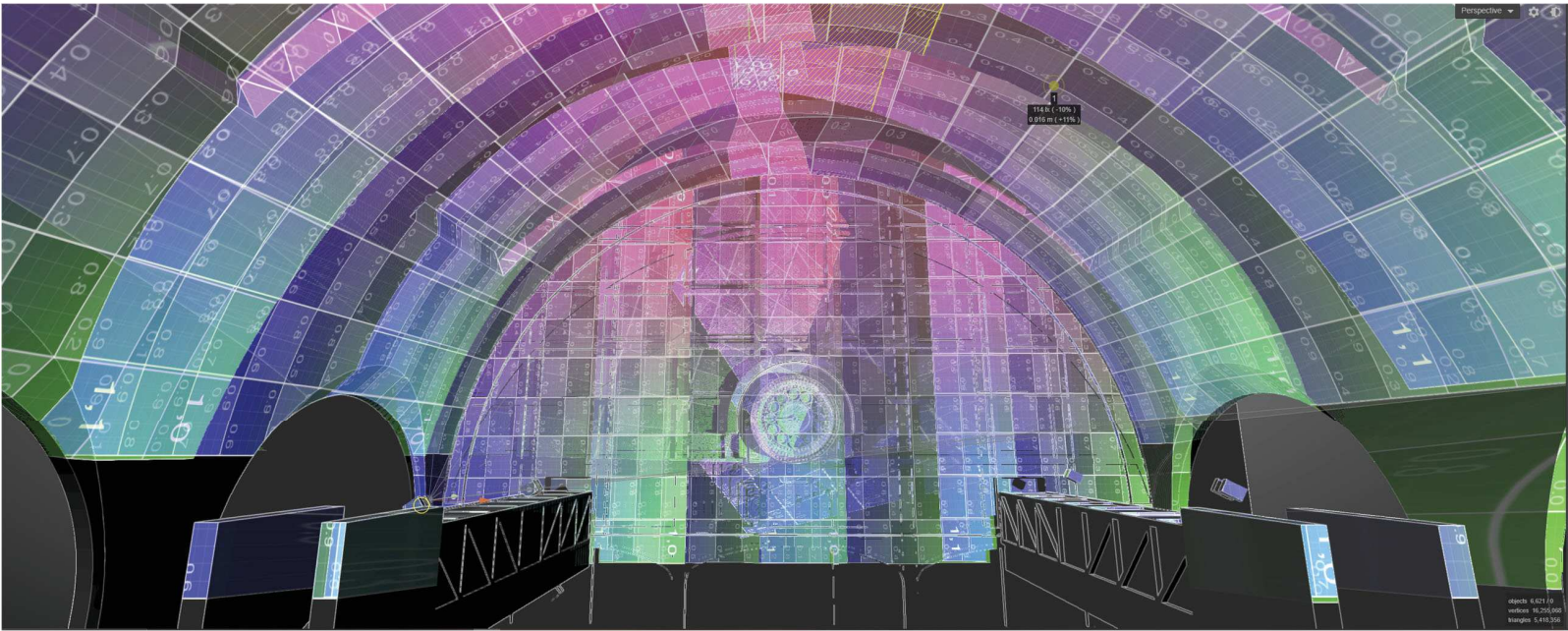













Zone de couverture  
Plafond Coté TOUR









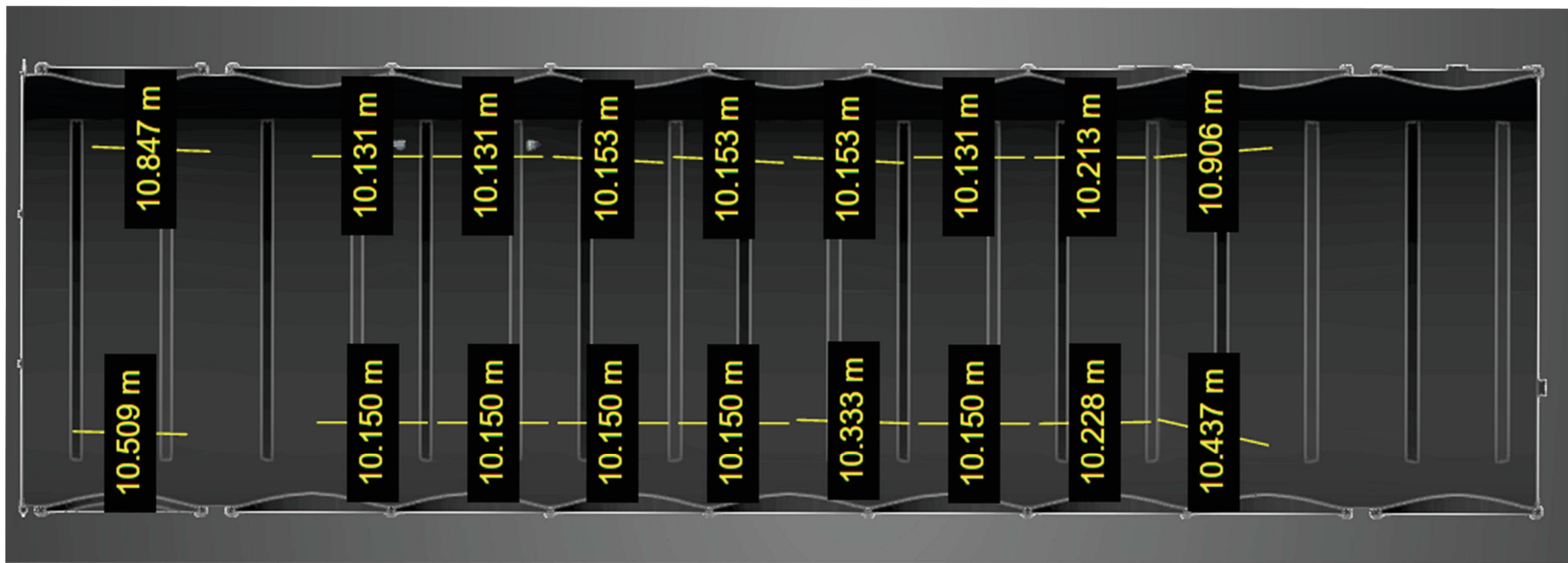





Synoptique v					Légende :		
Document Name :	MAG_TEMPLATE_Visio_V2		Version :	1	SMF DUO	BEETEK 4x LC	XLR Intercom
Author :	Anthony Martel	Co-author :	99 Rue de Paris 95500 Gonesse - FR		SMF QUAD	DISPLAY PORT	XLR Audio
Mail :	A.martel@magnum.fr	Venue :			MTP12	SDI	
Tel :	+33 1.30.11.60.90	Print :			MTP24	HDMI	
					USB	RJ45	



<div> <a href="http://www.magnum.fr">www.magnum.fr</a></div>	Synoptique v									
	Document Name :	MAG_TEMPLATE_Visio_V2			Version :	1	Légende :			
	Author :	Anthony Martel	Co-author :				 SMF DUO	 BEETEK 4x LC	 XLR Intercom	
	Mail :	A.martel@magnum.fr	Venue :	99 Rue de Paris 95500 Gonesse - FR			 SMF QUAD	 DISPLAY PORT	 XLR Audio	
	Tel :	+33 1.30.11.60.90	Print :	05/03/2025			 MTP12	 SDI		
							 MTP24	 HDMI		
							 USB	 RJ45		



  <a href="http://www.magnum.fr">www.magnum.fr</a>	Synoptique v							
	Document Name :	MAG_TEMPLATE_Visio_V2		Version :	1	Légende :		
	Author :	Anthony Martel	Co-author :			 SMF DUO	 BEETEK 4x LC	 XLR Intercom
	Mail :	A.martel@magnum.fr	Venue :	99 Rue de Paris 95500 Gonesse - FR		 SMF QUAD	 DISPLAY PORT	 XLR Audio
	Tel :	+33 1.30.11.60.90	Print :	05/03/2025		 MTP12	 SDI	
					 MTP24	 HDMI		
					 USB	 RJ45		



# Mur de l'horloge :

200 Lux - 3 Dual de 35K sur 23M de base sur la tranche

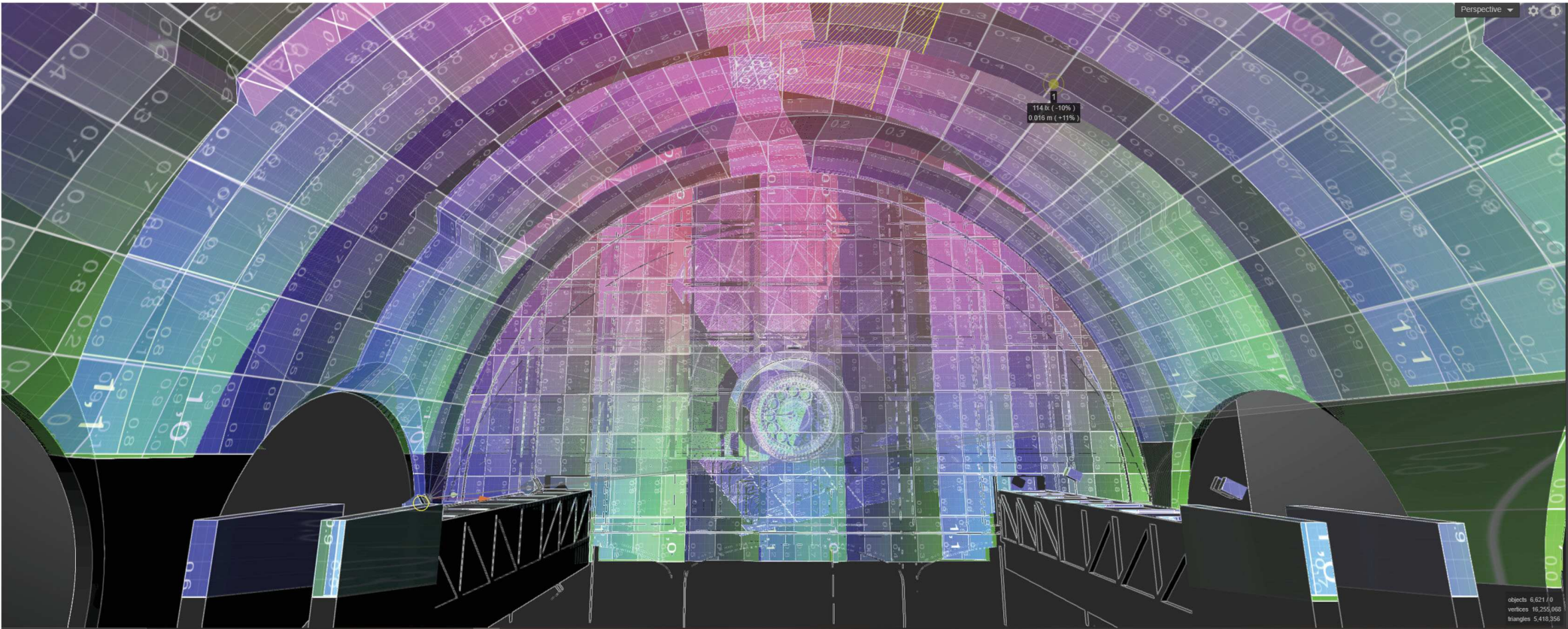

Synoptique v					Légende :		
Document Name :	MAG_TEMPLATE_Visio_V2		Version :	1	SMF DUO	BEETEK 4x LC	XLR Intercom
Author :	Anthony Martel	Co-author :	99 Rue de Paris 95500 Gonesse - FR		SMF QUAD	DISPLAY PORT	XLR Audio
Mail :	A.martel@magnum.fr	Venue :			MTP12	SDI	
Tel :	+33 1.30.11.60.90	Print :			MTP24	HDMI	
05/03/2025				USB	RJ45		



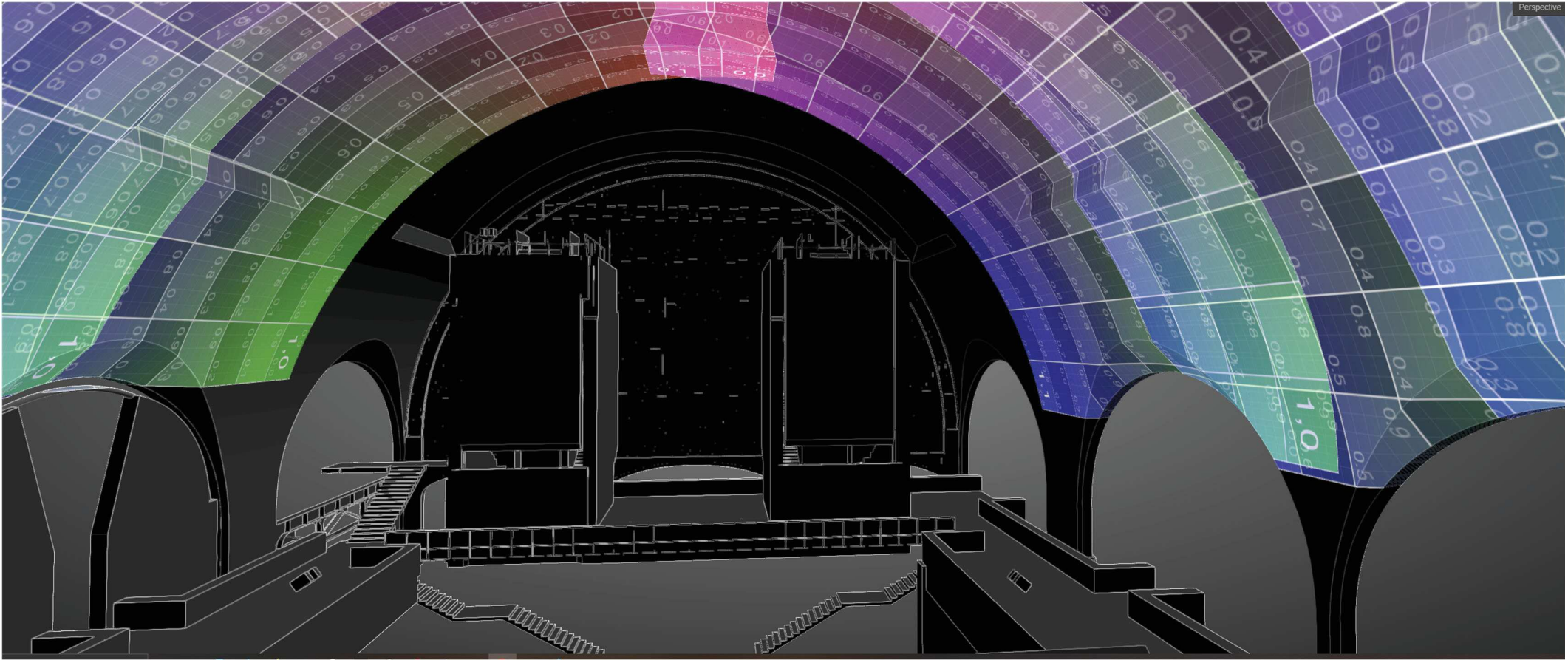

Synoptique v						
Document Name :	MAG_TEMPLATE_Visio_V2		Version :	1	<div>Légende :</div> <div><div><div><div></div></div> SMF DUO</div><div><div><div></div></div> SMF QUAD</div><div><div><div></div></div> MTP12</div><div><div><div></div></div> MTP24</div><div><div><div></div></div> USB</div></div> <div><div><div></div></div> BEETEK 4x LC</div> <div><div><div></div></div> DISPLAY PORT</div> <div><div><div></div></div> SDI</div> <div><div><div></div></div> HDMI</div> <div><div><div></div></div> RJ45</div> <div><div><div></div></div> XLR Intercom</div> <div><div><div></div></div> XLR Audio</div>	
Author :	Anthony Martel	Co-author :				
Mail :	A.martel@magnum.fr	Venue :	99 Rue de Paris 95500 Gonesse - FR			
Tel :	+33 1.30.11.60.90	Print :	05/03/2025			

4 projecteurs pour faire le plafond avant coté Tympan de l'horloge  
 Les projecteurs peuvent etre installés au dessus des passerelles dans l'axe.  
 Le tout en restant dans les 100 Lux Homogenes avec le reste du plafond.

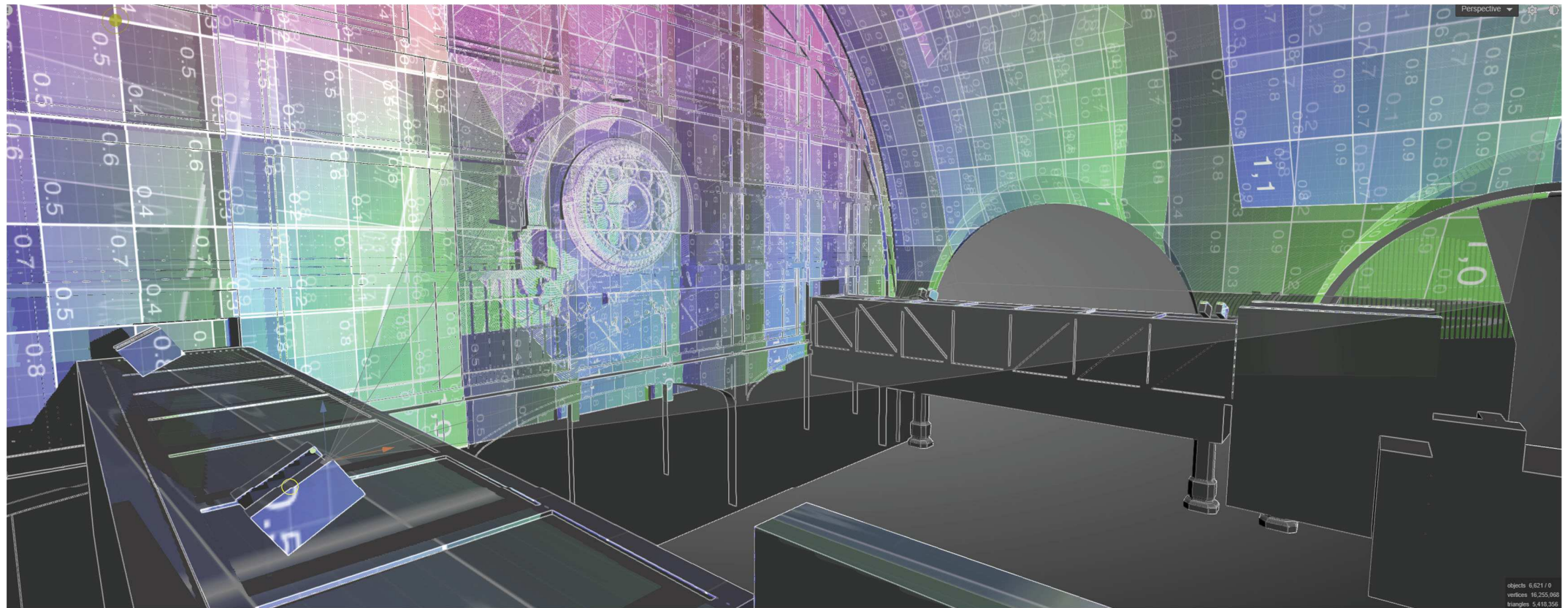

Synoptique v					Légende :		
Document Name :	MAG_TEMPLATE_Visio_V2		Version :	1	SMF DUO	BEETEK 4x LC	XLR Intercom
Author :	Anthony Martel	Co-author :			SMF QUAD	DISPLAY PORT	XLR Audio
Mail :	A.martel@magnum.fr	Venue :	99 Rue de Paris 95500 Gonesse - FR		MTP12	SDI	
Tel :	+33 1.30.11.60.90	Print :	05/03/2025		MTP24	HDMI	
					USB	RJ45	